

Works for both
45mm & 60mm
blades.

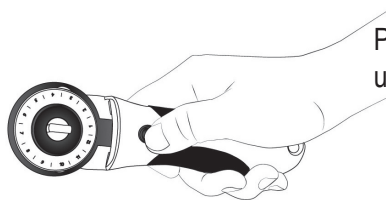

Rotary Blade User Guide Blade Change:

Right Handed or Left Handed Use:



Press the button to
unlock the blade cover.

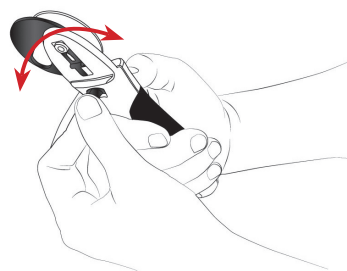

While holding the button down,
slide the lever left or right to
move the blade cover.

Changing the Blade:

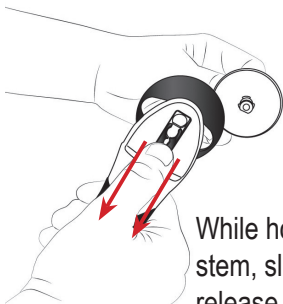

While holding the magnetic
stem, slide the lever down to
release the blade.

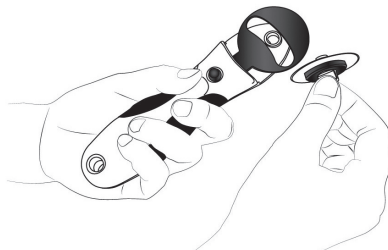

Pull the magnetic stem from base.

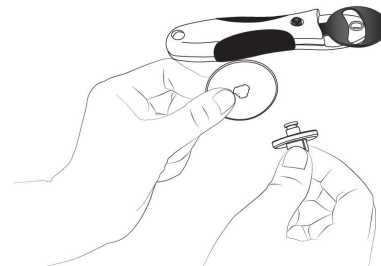

Remove the old blade and
replace it with the new one.

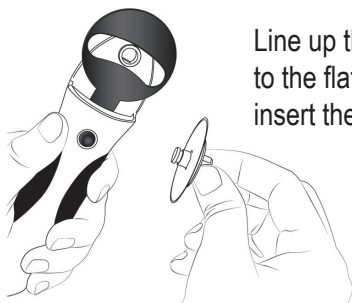

Line up the flat edge of the stem
to the flat edge of the hole and
insert the stem into the hole.

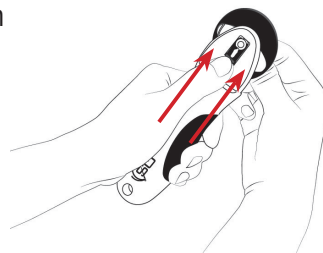

While holding the stem into
place, slide the lever up to lock
the blade into place.



Scan this QR code for a video demonstration.



See other side for more instructions. >>>

Works for both
45mm & 60mm
blades.



Rotary Blade User Guide Parts Change:

Changing Parts:

Remove the magnetic stem and blade using a tool with a flat end to remove soft plastic parts of the handle and the lock mechanism.

Take off the soft parts of the handle.

NOTE: The lock mechanism will be replaced, do not be concerned if the mechanism is damaged during removal.

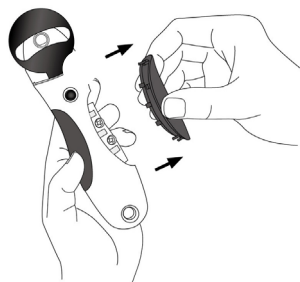
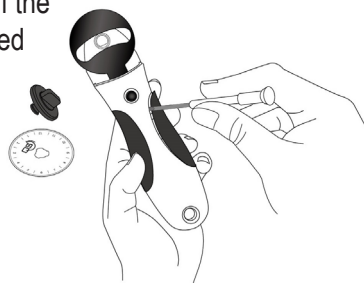

Remove the 4 screws using a Phillips-head screwdriver. Remove the upper body of handle to change the button/blade, guard/spring, etc...

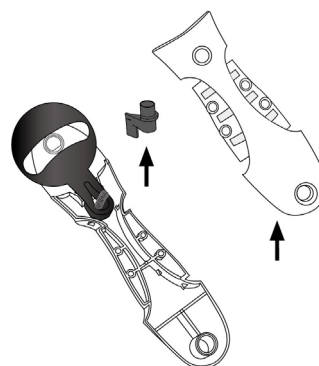
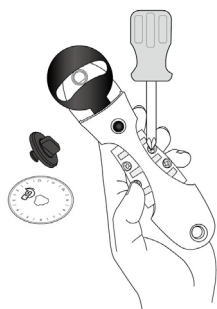

Keep this side up.

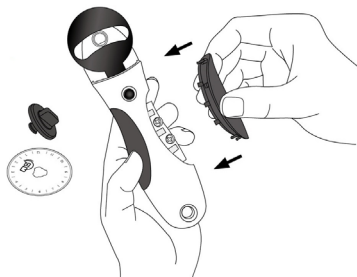

Scan this QR code for a video demonstration.