

DESIGN N STITCH

with Quilters Select

Alexandria Bay

Designed by Nicole Gilbert



Recommended Rulers & Notions:

- Quilters Select 6.5" x 12" Non-Slip ruler
- Quilters Select 3"x12" Non-Slip Ruler
- Quilters Select Self Erase Marker

Block Skill Level

Confident Beginner

Unfinished block: 12.5" x 12.5"

Techniques used:

"Speed Stitch" construction. *For best results prepare fabrics with starch prior to cutting.*

Read through all instructions before beginning.

HST = Half Square Triangle

QST = Quarter Square Triangle

RST = Right Sides Together

Fabric Selection:

- Construction of HST and QST units in this block use "Speed Stitch" techniques that are best used with scatter prints, solids or other non-directional fabrics.
- The center unit and small red squares in the illustration are perfect for fussy cut fabrics.

Cutting:

Fabric A: Cut 2: 5 1/2" Squares

Fabric B: Cut 1: 5 1/2" Square

Cut 4: 2 1/2" Squares

Cut 2: 4" Squares

Fabric C: Cut 1: 4 1/2" Square

Fabric D: Cut 4: 2 1/2" Squares

Fabric E: Cut 2: 4" Squares

Fabric F: Cut 1: 5 1/2" Square

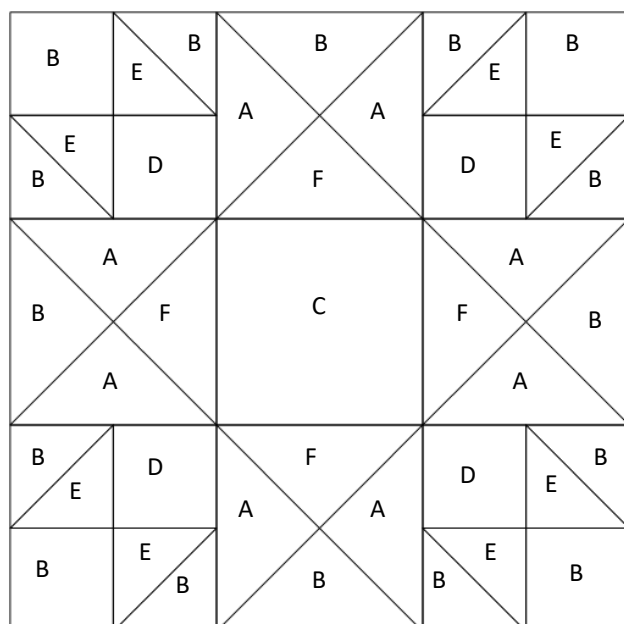

DESIGN N STITCH

with Quilters Select

Speed Stitch: *Four at a Time HST*

- Place **Fabric B and Fabric E** 4" squares right sides together.
- Stitch around all 4 edges.
- Cut units from corner to corner in both directions.
- Open each resulting half-square unit. Press seam allowance open; trim unit to 2 1/2".
- Repeat for remaining **Fabric B and Fabric E** 4" squares for a total of 8 half square units.

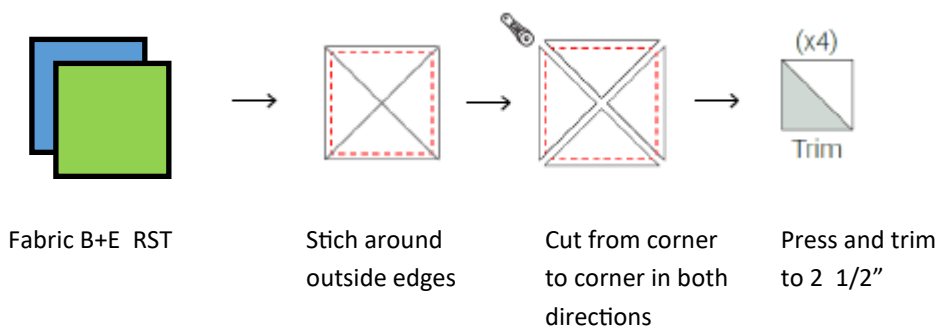

Speed Stitch: *Two at a Time > Quarter Square Triangle Units*

- Place **Fabric F and Fabric A** 5 1/2" squares right sides together.
- Draw line diagonally from corner to corner.
- Stitch 1/4" away one each side of the drawn line.
- Cut along the line to separate the two units. (Segment 1) Press seam open.

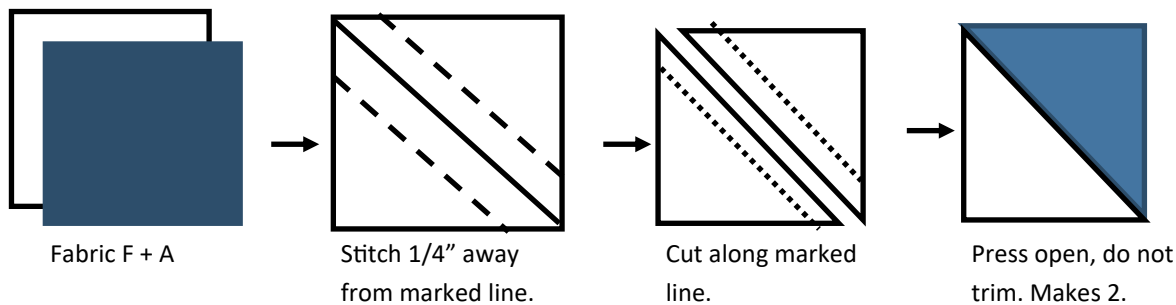

- Repeat with **Fabric A and Fabric B** 5 1/2" squares. (Segment 2)

DESIGN N STITCH

with Quilters Select

Speed Stitch: *Two at a Time* > Quarter Square Triangle Units *cont.*

- Place a **Segment 1 unit right sides together over a Segment 2 unit**; opposing colors together and seam lines aligned.
- Draw line diagonally from corner to corner, intersecting the seam line.
- Stitch $1/4''$ away one each side of the drawn line.
- Cut along the line to separate the two units. Press seams open and trim unit to $4\ 1/2''$.



HST units, RST opposite colors together.

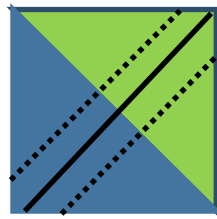

Stitch $1/4''$ away from marked line.

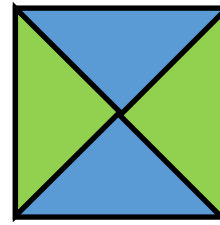

Cut along marked line. Open, press and trim to $4\ 1/2''$ square.

- Repeat with remaining Segment 1 & 2 units for a total of four Quarter Square Triangle units.

Put it All Together:

- Make 4:
 - Join Fabric B $2\ 1/2''$ square to HST unit .
 - Join Fabric D $2\ 1/2''$ square to HST unit.
 - Join the segments together to form 4-patch unit.



+



=



DESIGN N STITCH

with Quilters Select

Put it All Together: cont.

- Row 1: Join 4 patch unit + QST + 4 patch unit.
- Row 2: Join QST+ Fabric C + QST.
- Row 3: Join 4 patch unit + QST + 4 patch unit.

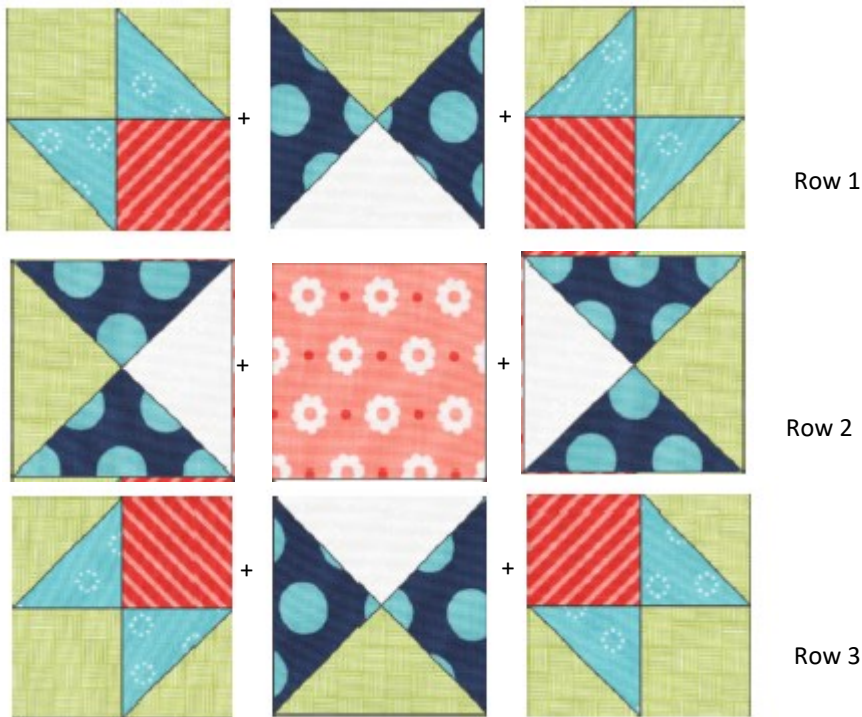

- Join Rows 1 + 2 + 3 to complete the block.